

## EB2852

### Bottom Loading

## Value Added Loading Arm Systems for Road and Rail

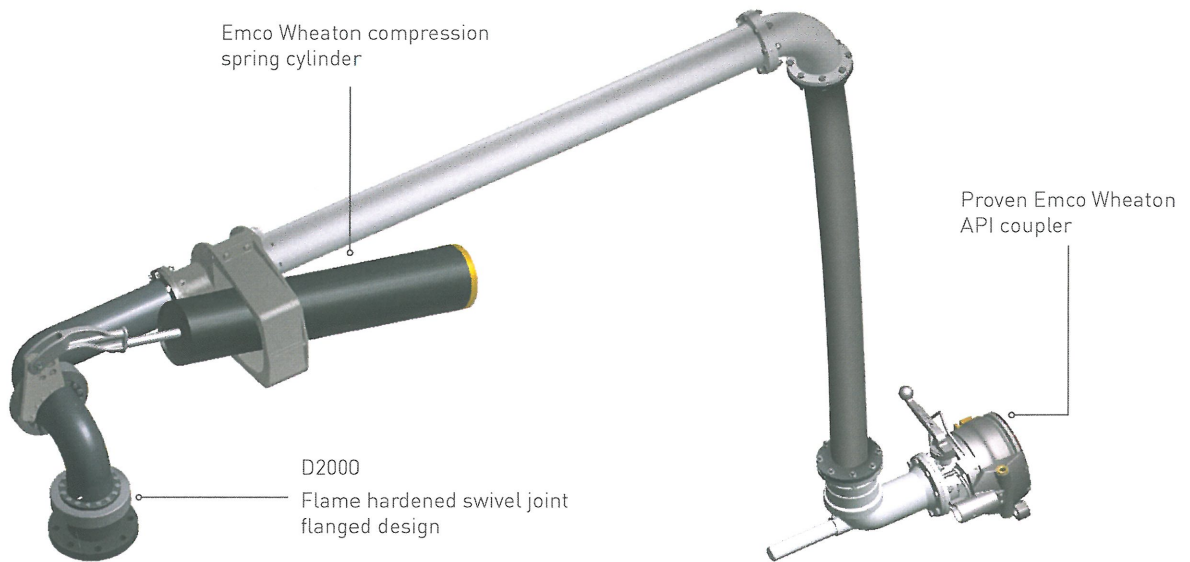

Developed for bottom loading and unloading of road and rail tankers and compatible with all types of fuels, this type of loading arm achieves excellent side connection using a 4" API coupler.

Loading arm dimensions are further designed to allow for the covering of the complete API connection area.

Size: 4" DN100

Right hand design / left hand design

Product entry from below / Balanced by spring cylinder

Design pressure: 16 bar up to the flange

Design temperature: -40° - 50°C

Product: oil products

#### MATERIALS:

- Inlet flanges - C 22.8 / ASTM A 105
- Pipes, elbows at Inlet - Carbon steel Cast EN-GJS-350-22
- Swivel joint Bearing module - 42CrMo4 / Aluminium
- Swivel joint seals - Viton
- Cylinder Bracket - G-AlSi7Mg0,3
- A-length / connection swivel joint - AIMGSi 1 F32
- Hose - Rubber composite steel

#### DIMENSIONS:

- A = 1200 - 2.000 mm
- B = 1.900 - 3.900 mm

Dimensions can be adjusted according to the requirements of the installation.

#### CONNECTIONS:

- 4" Inlet flange to ASA 150 LB R / F / EN 1092

#### PAINTING:

- One coat of EMCO standard Primer on all external carbon steel parts, 40 µm
- Others available on request

#### COMPONENTS:

- 2 off D2000 carbon steel swivel joints, internally flanged, sealing surfaces are micro finished, flame hardened ball raceway
- 1 off ali swivel joint, internally flanged at connection
- Spring cylinder for balancing of up and down movement
- API Dry break coupler type J0... (per Option).
- Vent plug on top of the apex elbow
- Composite hose TTMA flanged
- Others available on request

#### STANDARD DOCUMENTATION:

- Envelope drawing
- Loading arm drawing and parts list
- Standard Installation, Operation and Maintenance Manual
- Certificate of conformity
- Others available on request

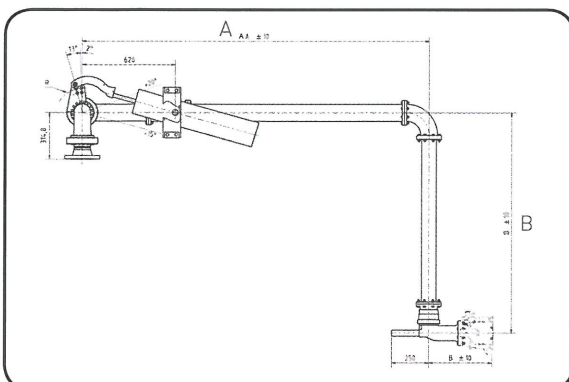

Plan View

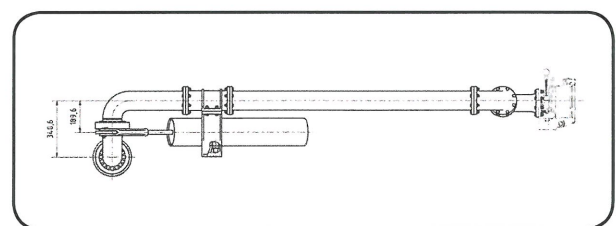

Top View